

**TECHNICAL DATA SHEET**



**MATERIAL**

DMX uses a specially formulated Polypropylene that provides a high environmental stress crack resistance to alkalines and acids found in the soil. In addition, DMX is made from 100% virgin resin. Our special extrusion process utilizes low heat and low shear to prevent heat degradation in the final product. The use of antioxidants and lubricants further ensure a smooth, superior quality membrane that outperforms the competition.

**PROPERTIES**

The DMX Drain 15X™ drainage board finished product has a 10mm dimple height, providing a drainage capacity of 20 gal/min/ft of width and a compressive strength of 15,000lbs/sq ft. Polypropylene is highly resistant to chemical interaction and has a life expectancy of up to 50 years when properly installed in accordance with the manufacturer's instructions.

**TECHNICAL DATA**

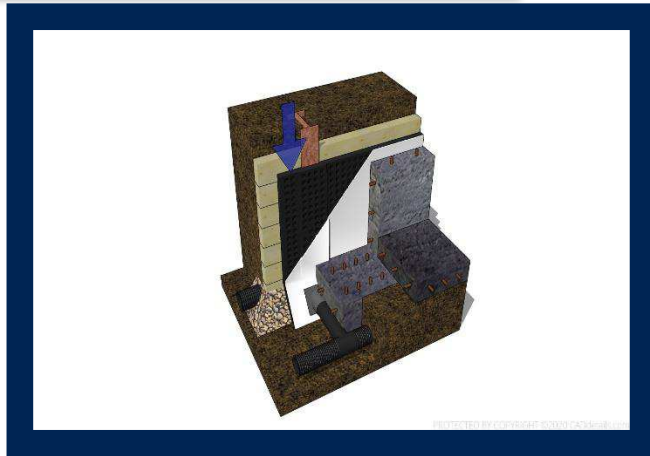
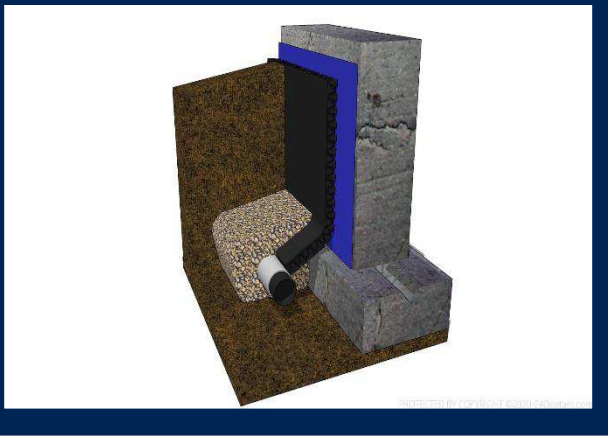

DRAINAGE CORE	TEST METHOD	IMPERIAL	METRIC
Colour	Black		
Dimensions (W x L)		4 x 50ft, 6 x 50ft	1.22 x 15.25m, 1.83 x 15.25m
Compressive Strength	ASTM D 1621	15000 psf (104 psi)	718 kNm <sup>2</sup>
Thickness	ASTM D 1777	7/16 inch	10 mm
Material	Polypropylene		
FILTER FABRIC		NON-WOVEN	
Grab Tensile Strength	ASTM D 4632	90 lbs	0.401 kN
Grab Elongation	ASTM D 4632	50%	50%
Trapezoid Tear Strength	ASTM D 4533	40 lbs	0.178 kN
CBR Puncture Resistance	ASTM D 6241	265 lbs	1.178 kN
Permittivity	ASTM D 4491	2.0 sec <sup>-1</sup>	2.0 sec <sup>-1</sup>
Water Flow	ASTM D 4491	150 gpm/ft <sup>2</sup>	6095 l/min/m <sup>2</sup>
Apparent Opening Size (AOS)	ASTM D 4751	50 Std. U.S. Sieve	0.300 mm
UV Resistance	ASTM D 4355	70%/500 hrs	70%/500 hrs
COMPOSITE SYSTEM			
Water Flow Rate (V)	ASTM D 4716	20 Gal/min/ft	248 L/min/m
Roll Size		4ft x 50ft, 6ft x 50ft	1.22m x 15.25m, 1.83m x 15.25m
Roll Weight		40 lbs, 55 lbs	18 kg, 25 kg
Fabric Weight		5lbs, 8 lbs	2.4kg, 3.6 kg