



Foundation Wrap

Installation Manual

Foundations

Version 4.6.2^φ

(*) - Denotes Current Revisions throughout this Installation Manual Version 4

(^φ) - Denotes Current Revisions for Version 4.6 of this Manual

Manual updated February 23rd, 2024

Table of Contents

Legend of Symbols	1
Planning the Job	2
Supplies Required	2
Tools Required	3
Preparing the Site	3
Where to Start?	4
Overview	5
Introducing DMX AG TM Use Case 1	6
Introducing DMX AG TM Use Case 2	7
Installing DMX AG TM	8
Corners	10
Joining Rolls of DMX AG TM	11
Windows	13
Service Entrances	14
Sealing the Top of the Membrane	17
Sealing the End of the Roll	18
Patching the Membrane	19
Backfilling	20
Repairing Foundation Cracks	20

Legend of Symbols



Optional Sealant Placement

(Sealants are optional, except in Waterproofing/Repair)



Hints for better quality installation



Important installation guides



Engineer required for Structural Issues



Supplies Required

Rolls of DMX AG™	<ul style="list-style-type: none">❖ 1 roll for every 65.5 feet (20 meters) of foundation perimeter.❖ Choose the height that matches the distance from the footing to the grade line.❖ DMX AG™ comes in a variety of heights up to 8 feet (2.4 meters). For taller foundations you can overlap the top layer of DMX AG™ over the bottom layer by at least 6 inches (150 mm) and mesh the dimples.
DMX FlexTrim™	<ul style="list-style-type: none">❖ For sealing cut edges in the membrane where the flat panel has had to be trimmed off, such as around windows or on a slope. The DMX FlexTrim™ prevents dirt from getting between the membrane and the wall.
DMX Washers™	<ul style="list-style-type: none">❖ For use with nails or screws on both the flat tab and dimpled section of membrane.❖ DMX approves the use of washers as follows:<ul style="list-style-type: none">Flat Tab on Membrane: Plastic Washers or FlexTrim*Dimpled Section of Membrane: Plastic Washers or Steel Washers with a rubber insert to protect damage to the sheet.❖ Approximately 200 Washers per roll of DMX AG™.
1 ¼ inch concrete nails (for poured or concrete block foundations) OR 1 ½ inch deck or drywall screws (for ICF* & PWFφ foundations)	<ul style="list-style-type: none">❖ For fastening the flat tab at the top of the DMX AG™ to the foundation. Use one nail or screw with a washer every 6 to 8 inches* (150 to 200 mm).❖ For fastening DMX Washers™ into the dimples.❖ For fastening DMX FlexTrim™.

*ICF applications have not been evaluated by CCMC

Tools Required

Utility knife	For cutting the membrane
Chalk line	For marking the grade level on the foundation wall
Drill	For ICF* foundations. Cordless is the most convenient. *ICF applications have not been evaluated by CCMC
Hammer or power nail gun	For poured or concrete block foundations. New or green concrete can be nailed by hand. Cured walls and block walls are more easily dealt with using a power nail gun.
Adapter	For holding the DMX Washers™ when you are using a power nail gun.

Preparing the Site

- ❖ Make sure the foundation is clean at the grade level.

- ❖ Clear off the footing.

This makes it easier to roll out the membrane smoothly. We recommend that you install the membrane **before** covering the drainage tile with stone, or at least keep the stone away from the footing until after the membrane is installed.

- ❖ Make sure you have good drainage at the footing in accordance with local Code Requirements*.

Drainage is vital to the success of your project, and the optimum performance of DMX AG*. Any moisture that collects behind the membrane is designed to flow to the drainage tile* at the footing. It is extremely important for the drainage tile* to be functioning properly.

- ❖ You can install the DMX AG™ membrane in any type of weather, we suggest for productive installations that DMX AG not be installed in temperatures below -24°F (-31°C)*.
- ❖ When dewatering follow local By-Laws/Rules about discharging rain water on public or private property*.

Where to Start?

If you will be wrapping the whole foundation, start away from any corners or angles in the wall. This lets you overlap the membrane in a convenient place.

If the foundation has an attached garage, wrap the exterior walls of the house as well as the inside of the garage excavation, where the foundation of the house meets the garage. The membrane should extend at least 6 inches (150 mm) past the house foundation.

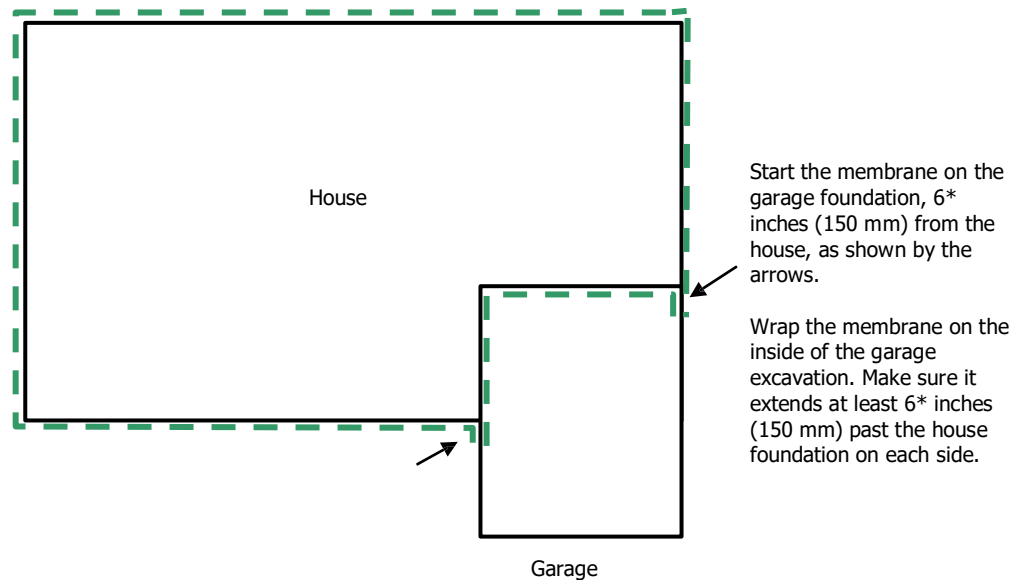

Overview

This is a quick simplified view of what is involved in installing DMX AG™. The rest of this guide provides the details

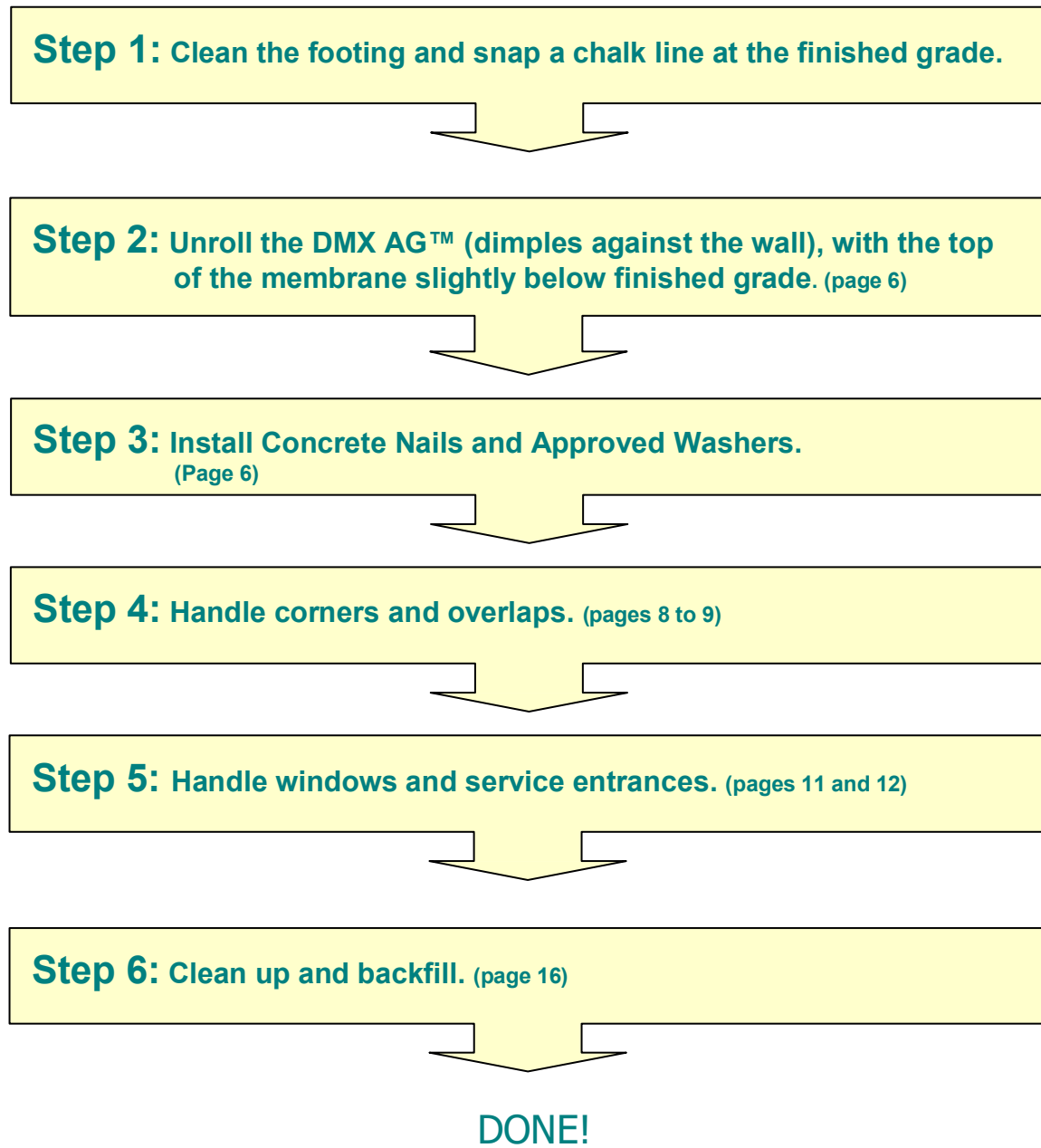

Planning the Job

Introducing DMX AG™

DMX AG™ is a dimpled plastic membrane with a flat tab on one side. To install it, you will basically wrap it around the foundation with the flat tab at the top, attaching the top of it to the foundation wall using DMX washers and nails. You can apply a ½" wide x ½" thick sealant bead between the flat tab and foundation if desired*.

This is a simplified view:

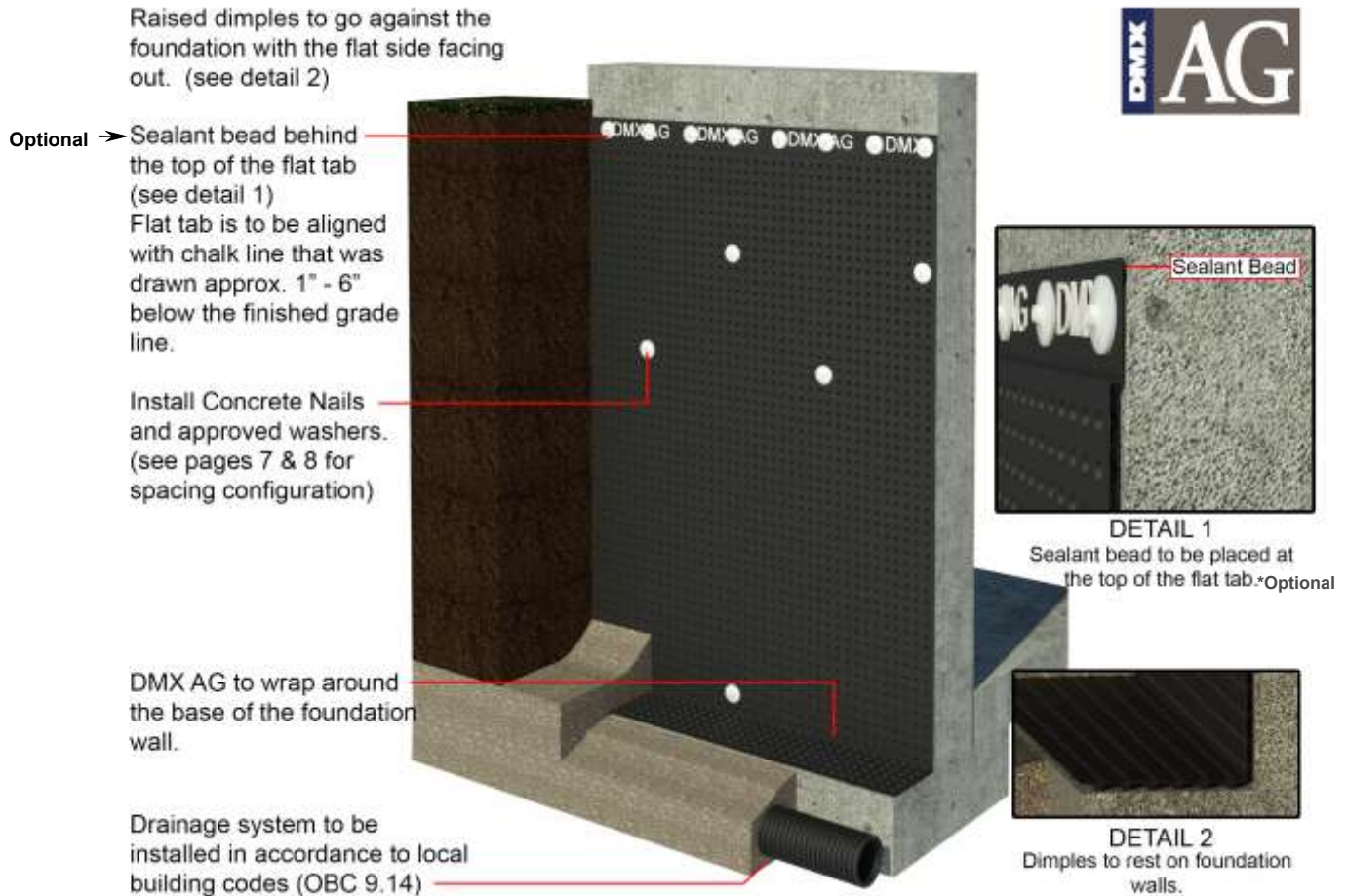

Planning the Job

Introducing DMX AG™

DMX AG™ is a dimpled plastic membrane with a flat tab on one side. To install it, you will basically wrap it around the foundation with the flat tab at the top, attaching the top of it to the foundation wall using DMX washers and nails, you can apply a ½" wide x ½" thick sealant bead between the flat tab and foundation if desired*.

This is a simplified view:

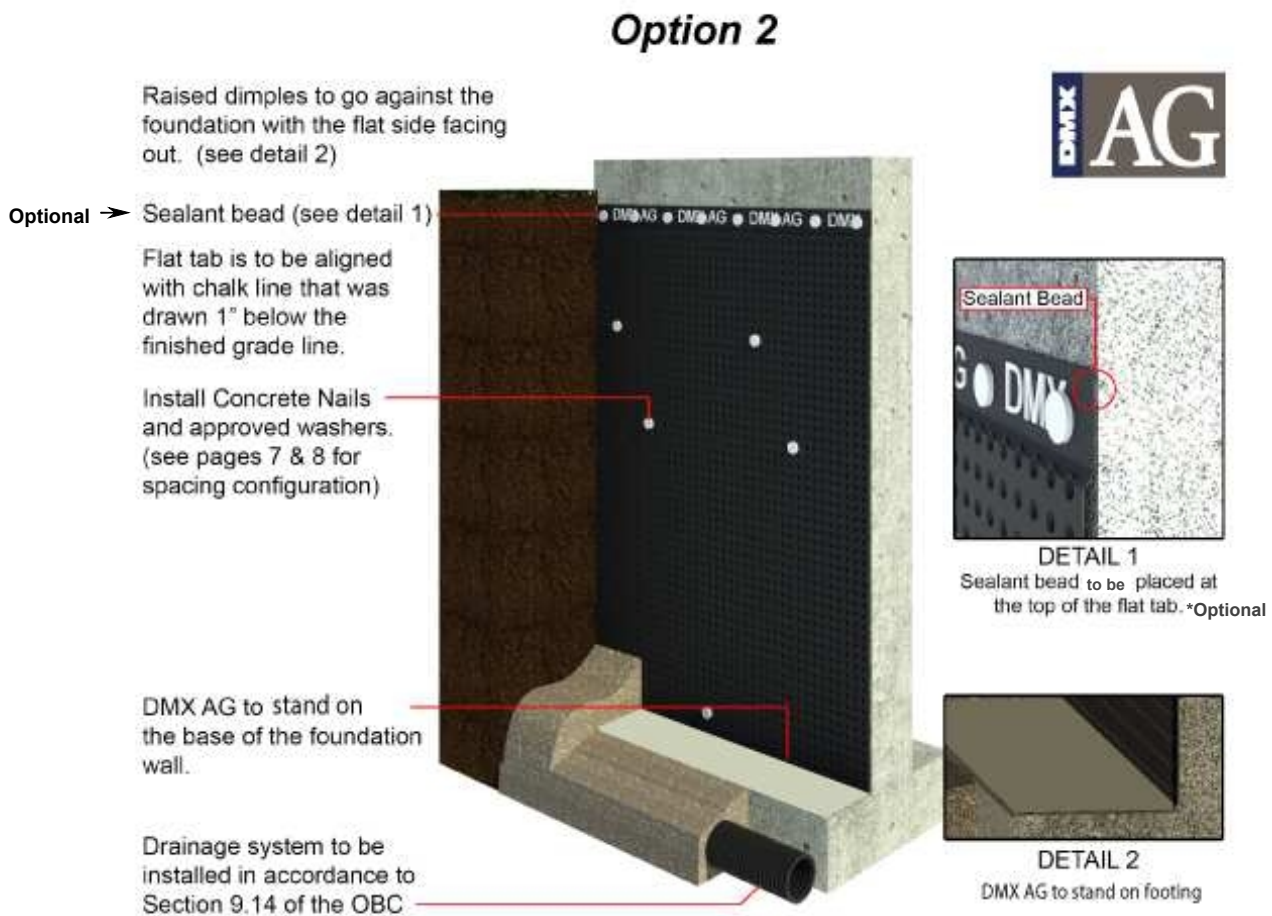

Installing DMX AG™

1. Snap a chalk line one to six inches below grade level, for dampproofing, on the foundation wall.
2. Roll out a small amount of DMX AG™ with the flat tab lining up with the chalk line. Keep the membrane as smooth as possible. The dimples (bumps) are placed against the wall as shown below:



Picture (Above): Real Photo of DMX AG Drainboard dimples



We recommend that two people install the DMX AG™ – one to unroll and smooth out the DMX AG™ and one to attach it to the foundation.

3. Secure the membrane to the foundation wall with DMX Washers™ and concrete nails. Please note, steel washers are not recommended but if used in the dimpled section of membrane, even if they are installed with a rubber or PVC insert they may compromise the membrane and are not covered under warranty.

Position the DMX Washers™ in the flat tab, 6 – 8 inches* (150mm – 200mm) apart, secure in place with 1 ¼ inch concrete nails.

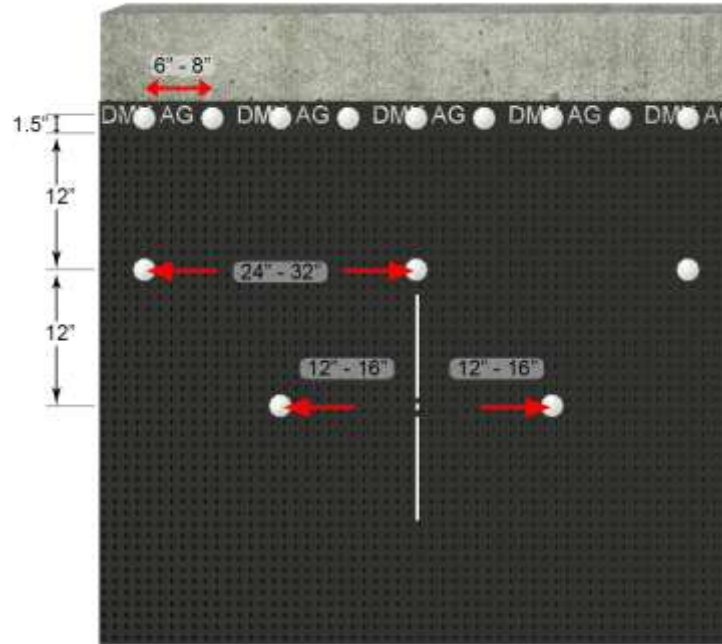

Picture (Above): Washer Placement Detail
(Picture resembles only the top portion of the wall.)

The first row of washers should be positioned approximately 12” – 14” (300mm – 350mm) below the washers located in the tab. The second row of washers is to be positioned 12” – 14” (300mm – 350mm) below the second row, but this row should be offset from the first row by approximately half the distance between washers 12” – 16” (300mm – 400mm). This should then create a “W” pattern. (please refer to diagram above for visual).

Washer Spacing may vary slightly depending on site conditions, final spacing of washers is left to the discretion of the DMX Certified Installer. DMX will warranty all work done by our Certified Installers.

If needed, a third row of washers can be positioned 12” – 14” (300mm – 350mm) below the second row but align this row with the washers located in the first row to continue the “W” pattern.



For ICF foundations*, please use 1 ½ deck or drywall screws instead of nails. The screws are to be anchored into the cross webs locations based on the diagram above.

*ICF applications have not been evaluated by CCMC



In heavy clay soil, we recommend that you insert a third row of washers 12 inches (300 mm) below the second row of washers, with a spacing of 12" to 14" (300 mm to 350 mm)*.

4. Insert a final row of washers approximately 2 - 4 inches (50 mm – 100mm) above the footing spaced 10 feet apart. This final row of washers will prevent the crushed stone from getting under the membrane.

Corners

It is important to fit the membrane tightly to corners. Fasten the membrane near the top and bottom by inserting washers. DMX recommends washers be placed 6 inches (150 mm) back from outside corners and 6 inches (150 mm) from inside corners or they may be located within 6 inches (150mm) of corners when installers previous experience has shown no structural damage to the foundation and membrane.



The use of a 2" x 4" wood stud will help form and hold the shape of interior corners!*

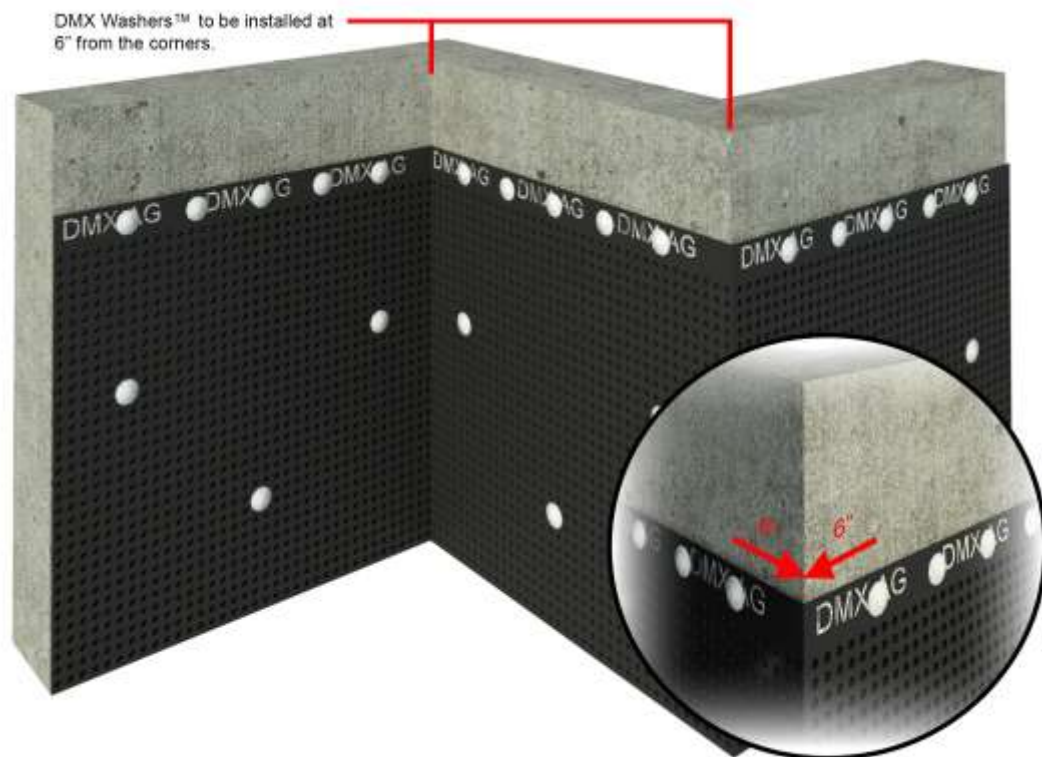

Picture (Above): Corner Wrap Detail (Picture resembles only the top portion of the wall.)

Joining Horizontal* Rolls of DMX AG™

When joining two pieces of DMX AG™ vertically, as shown below, overlap them by 6 inches (150 mm), apply a full bead of sealant* and mesh the dimples. It is not necessary to caulk the join if the overlap is 12" or more*. Insert DMX Washers™ along the overlap every 8" inches (200 mm).

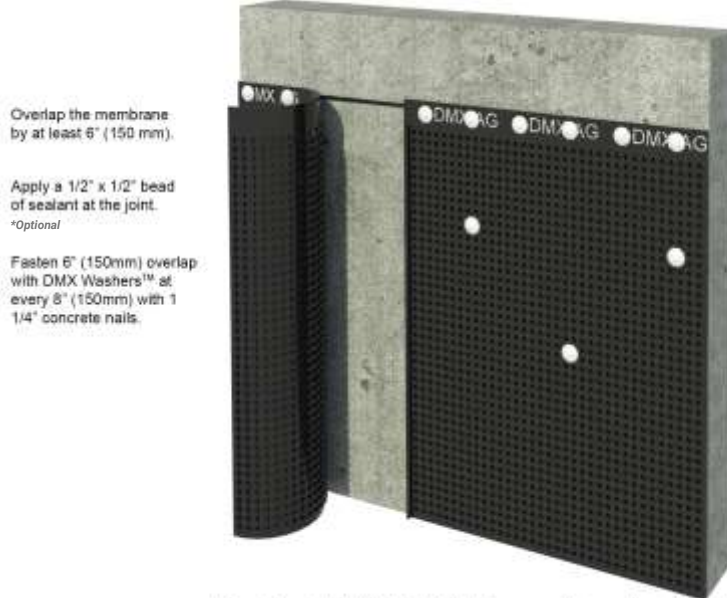

Overlap the membrane by at least 6" (150 mm).

Apply a 1/2" x 1/2" bead of sealant at the joint.
**Optional*

Fasten 6" (150mm) overlap with DMX Washers™ at every 8" (150mm) with 1 1/4" concrete nails.

Picture (Above): Vertical Joint Detail (Picture resembles a portion of the wall.)



If you are joining two pieces of membrane horizontally, install the lower piece first. The upper piece must cover the top of the lower membrane, overlapping it by at least 6 inches* (150 mm), apply a full bead of sealant to the join if the membrane is being applied as a wall waterproofing*. Install DMX Washers™ every 6 inches (150 mm) along the overlap.



Sealants to be used should be Elastomeric for concrete, wood or concrete block or Acrylic Latex/Polyurethane water based for ICF* and XPS based forms. Typical sizes are 250 mL and 500 mL tubes.

Elastomeric Sealants should meet ASTM C920, Type S, Gr. NS Class 25
Solvent Based Sealants should meet CGSB-19-GP-13.85M
Latex Sealants should meet ASTM C834, Type S, Grade NS, Class 25

*ICF applications have not been evaluated by CCMC



Over lap the top section over the bottom section by at least 6" (150 mm).

Apply a full bead of sealant along the horizontal joint. *Optional

Fasten 6" (150mm) overlap with DMX Washers™ at every 6" (150mm).

Picture (Above): Horizontal Joint Detail (Picture resembles a portion of the wall.)

Windows

For windows or other openings in the foundation, cut the membrane 6 inches (150 mm) back from the edge. Fasten the membrane to the foundation wall under the opening using DMX Washers™ as usual. Since you have trimmed off the flat tab, you must install DMX FlexTrim™ to seal the cut edges to within 6" (150 mm)* of the opening.

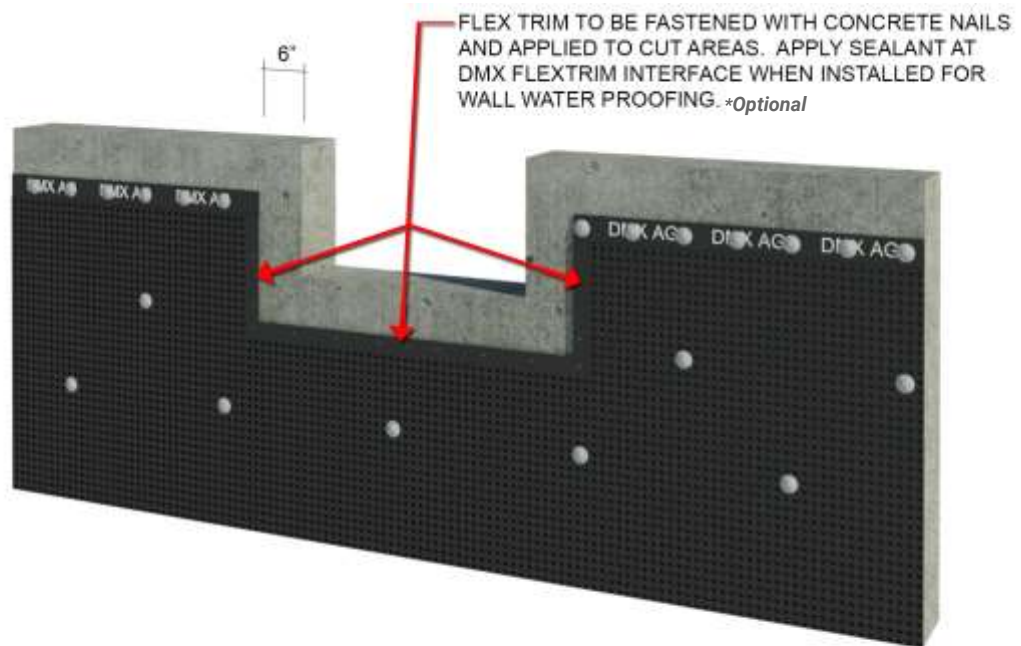

FOUNDATION CUTOUT DETAIL (ABOVE): CUT THE MEMBRANE BACK FROM THE EDGE OF OPENINGS IN THE FOUNDATION, MINIMUM 6".

When installing window wells, DMX allows the use of DMX AG in the horizontal area below the window. If the Flextrim could interfere with the seal between the concrete wall and the window well, the contractor can use a section of DMX AG, with the flat tab, properly secured and caulked horizontally, with a minimum cut back of 6".

Service Entrances (Service Penetrations Must be Sealed through Membrane)

Follow this procedure whenever there are penetrations in the foundation for services (gas, hydro, water and so on).



1. Caulk around the service that is penetrating the foundation.
2. Cut the membrane vertically so that it goes PAST the service at least 6 inches (150 mm)

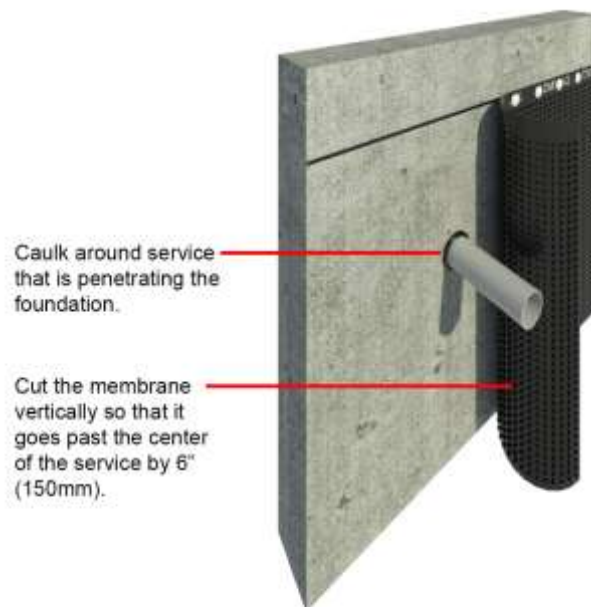

Picture (Above): Service Entrance Detail 1
(Picture resembles only the top portion of the wall.)

Field Notes and Dimensions

3. Cut the membrane to fit as tightly as possible around the service.



4. Caulk around the service again.

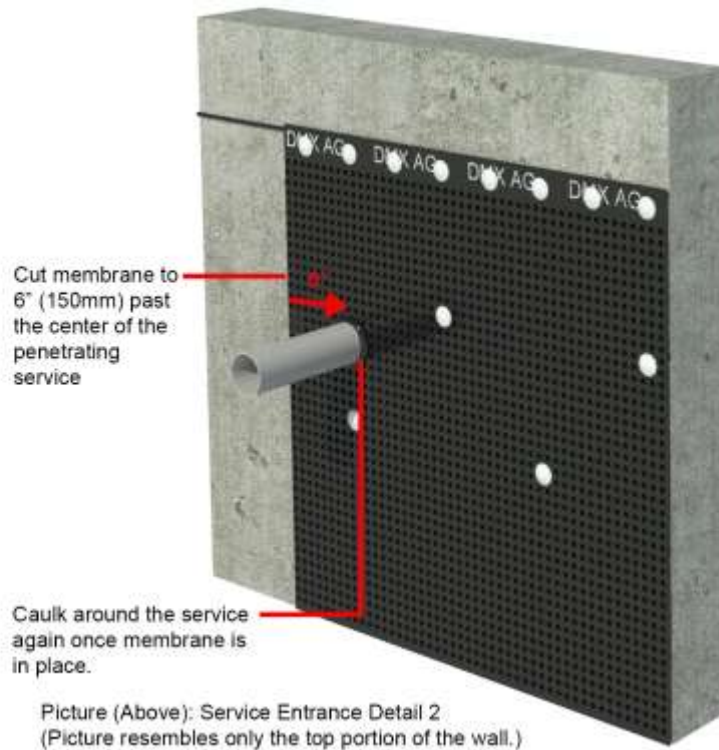

5. (Now there will be caulking around the service both under the DMX AG™ and on top of it.)

6. Start the next piece of membrane 6 inches (150 mm) BEFORE the service. (The idea is to have a 12-inch (300 mm) overlap at the service.) (If the overlay is 12 inches or greater, caulking is optional.)

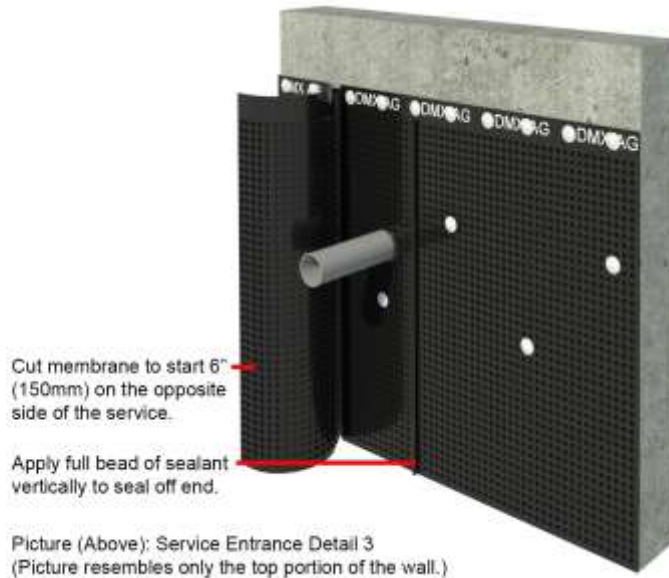

7. Cut the top layer of membrane to fit as tightly as possible around the service.

8. Caulk around the service again.



9. (Now there will be caulking under and on top of each layer for good protection.)

10. Insert DMX Washers™ along the overlapped membrane every 6 inches (150 mm)

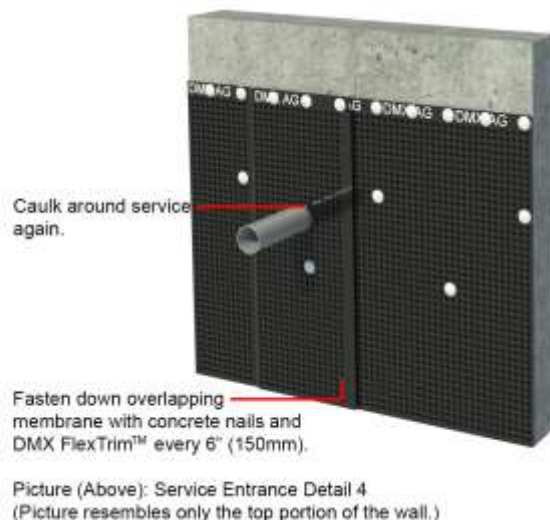

Sealing the Top of the Membrane

If the flat tab has been cut away, such as on a sloped grade or around windows, use DMX FlexTrim™ to seal this area. Set the DMX FlexTrim™ against the top of the membrane as shown below and nail every 6 inches* (150 mm)

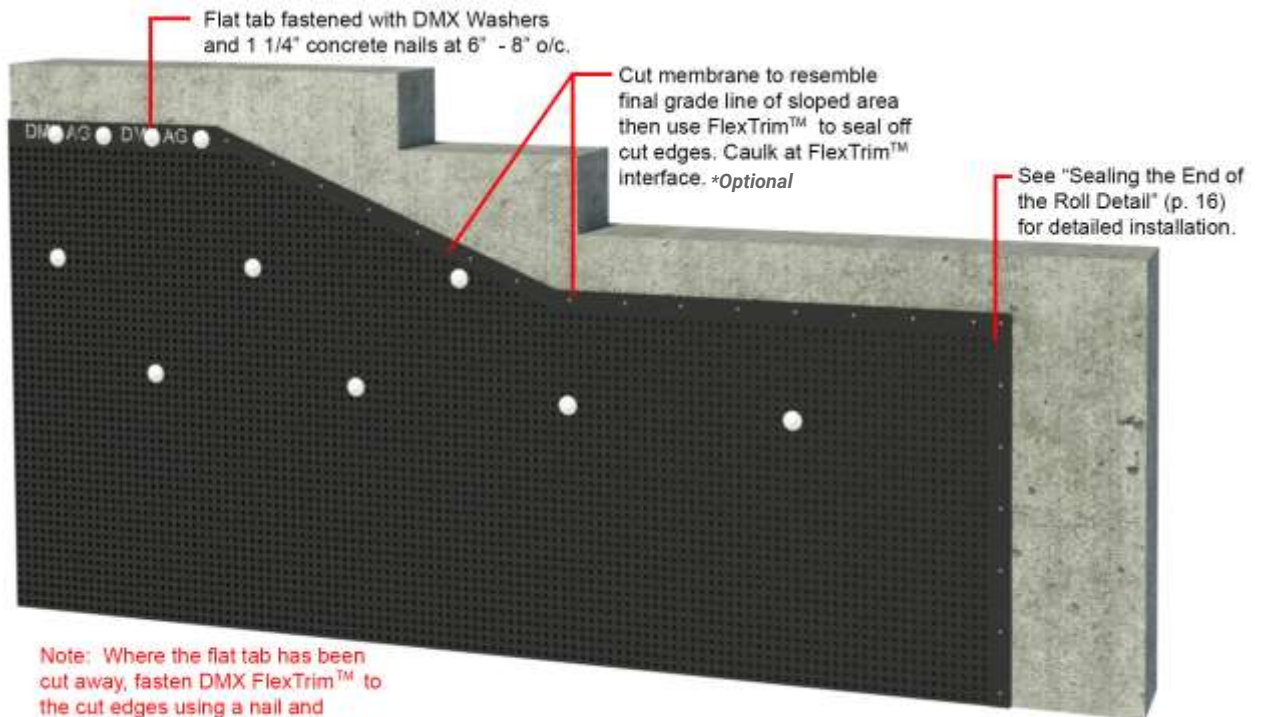

Note: Where the flat tab has been cut away, fasten DMX FlexTrim™ to the cut edges using a nail and washer. (or screw and washer for ICF foundations.)

Picture (Above): Change in Grade Detail (Picture resembles only the top portion of the wall.)

Sealing the End of the Roll

If you are not wrapping the entire foundation in DMX AG™, such as when there is an attached garage, you need to seal the vertical ends of the DMX AG™. Anchor the membrane to the foundation using DMX Washers™, including the vertical open end at 6 inches* (150 mm) spacing which will receive some closing trim. Then install DMX FlexTrim™ on the vertical edge just as you would for cut edges in the top of the membrane.

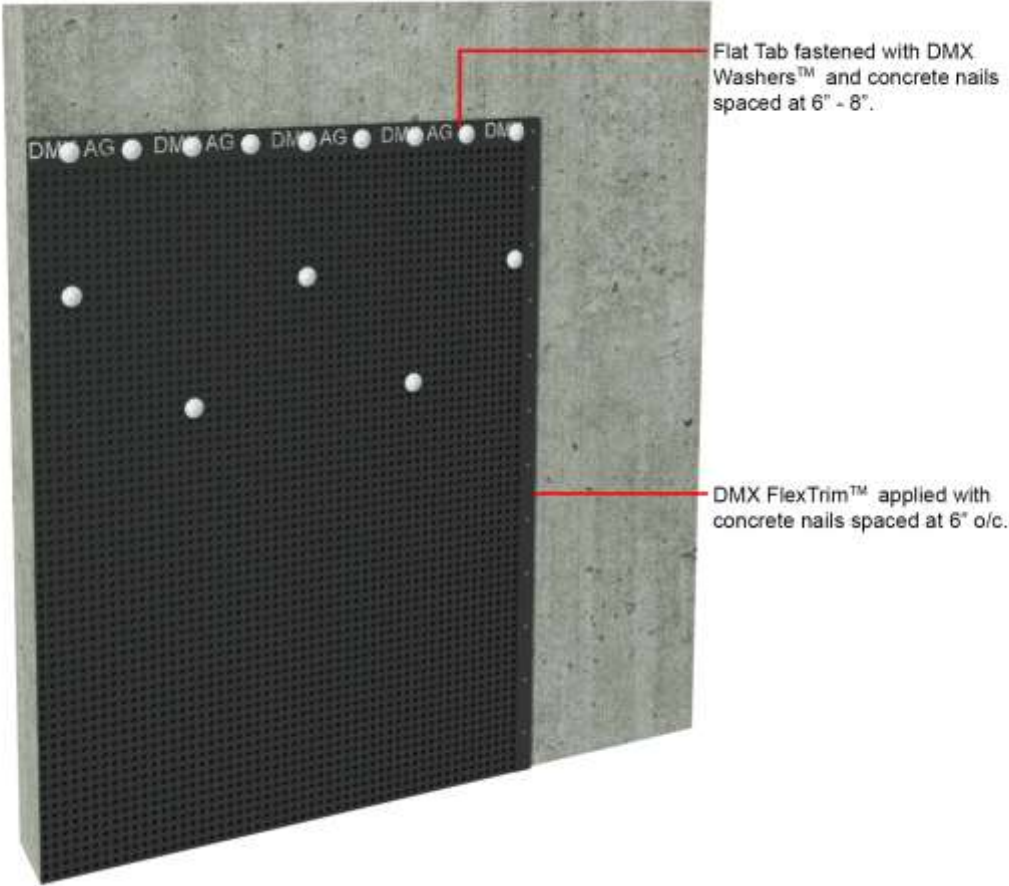

Patching the Membrane

If you need to patch the membrane because of a tear, use an extra piece of membrane that is at least 12 inches (300 mm) larger than the tear. Mesh the dimples, apply a full bead of sealant* and install DMX Washers™ in the corners of the patch. -> If the patch is 12 inches or greater on each side, caulking is optional.

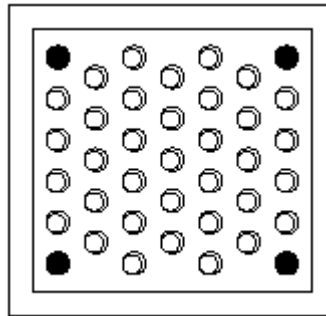
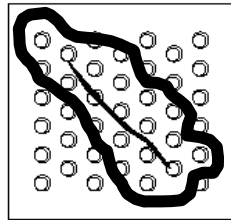

Depending on the size of the patch, you may need to install washers at the approved distance spacing as in the main bod



Backfilling – Follow Local Code Practices*

1. Cover the drainage system required by Code* with approved granular material using good engineering and construction practices.*
2. Carefully backfill the balance of the excavated area, by following good construction practices (**DO NOT DAMAGE DMX AG MEMBRANE**)*
3. Make sure the finished grade is just slightly above the top of DMX AG™, but not greater than 6".*



During backfill, avoid placing large rocks (> 6" dia.)* or frozen clumps against the wall. Ensure that the base of the excavation is not frozen when backfilling as this may be a sign of frozen earth beneath the footings which can lead to structural issues not related to a membrane installation. Excess settlement under slabs on grade is also possible.*



Repairing Foundation Cracks *

You can use the DMX AG™ membrane to cover small cracks in the foundation (up to ¼ inch (7 mm) wide) without wrapping the entire foundation. For larger cracks up to ½ inch (12.5 mm) the cracks should be repaired prior to installing the DMX AG as a protective layer and ground water control sheet.*

Excavate the soil around the crack right down to the footing. Clean the exposed area of soil and debris.* Install a piece of DMX AG™ membrane from the grade line to the footing. The membrane must extend 12 to 16 inches (300 to 400 mm) each side of the crack.

Use DMX Washers™ to fasten the membrane to the foundation at the required spacing* and seal the top and sides of the membrane in the same way as described earlier in this guide and around openings.* (Sealant and nails in the flat tab area, DMX FlexTrim™ on each side with sealant between membrane and trim.)* - Sealant is optional.

NOTE: As DMX AG is a membrane that is independent of the foundation and flexible, it is **NOT** to be used as a structural repair method for foundations requiring structural repairs as a stand alone system. It can be used in combination with approved structural repairs to a foundation to provide the necessary dampproofing, drainage and wall waterproofing required by the Codes.



Be sure to visit the DMX website for any current information which may be provided in the eos to supplement this Installation Manual at

www.dmxmembranes.com