



## SUPERIOR DRAIN BOARDS FOR HORIZONTAL AND VERTICAL DRAINAGE APPLICATIONS



**BETTER SCIENCE • BETTER PRODUCT**

# TABLE OF CONTENTS

<b>BENEFITS OF SPECIFYING DMX DRAIN BOARDS</b> .....	3
<b>INTRODUCTION</b> .....	4
<b>RESPECT FOR THE ENVIRONMENT</b> .....	5
<b>DMX DRAIN 5X</b> .....	6
<b>DMX DRAIN 11X</b> .....	7
<b>DMX DRAIN 15X</b> .....	8
<b>DMX DRAIN 15XP</b> .....	9
<b>DMX DRAIN 18X</b> .....	10
<b>TECHNICAL DATA</b> .....	11
<b>PHOTO GALLERY</b> .....	12



## BENEFITS OF SPECIFYING DMX DRAIN BOARDS

### ✔ Better Polymer Knowledge

DMX has almost 30 years of comprehensive knowledge of resins, blends, compounds and their effects on molecular chains of polymers, what works and what doesn't work for our drain boards.

### ✔ Better Production Capabilities

DMX utilizes the latest in continuous roll thermoforming technology which allows our drain boards to meet the strictest tolerances and gauges.

### ✔ Better Formulations

Using our advanced polymer knowledge, we are able to formulate blend recipes that maximize the performance of our drain boards by using anti-oxidants and compatibilizers.

### ✔ Better Pricing

In the construction industry, the biggest part of the value proposition is cost of the item or work, DMX delivers superior pricing with no compromise in quality, which makes our customers complete their waterproofing jobs on time and on budget!

### ✔ Better Testing

DMX has arguably the most advanced in-house testing lab in the industry:

- Notched Izod
- Compression Test
- Melt Index
- Density Test
- Tensile Test
- In-house 50 Ton Injection Molding Machine for rapid test samples
- Thermo-kinetic Mixer to rapid prototype new compounds and formulations ■



## INTRODUCTION

### DMX – Better Science, Better Product

DMX has been manufacturing dimpled membranes for approximately 16 years. In that time, DMX products have developed a reputation as the highest quality drain boards in the market.

Our drain boards are proudly manufactured in Canada, we are 100% Canadian!

At DMX we believe in giving the customer more, not less, so that our clients projects are completed with maximum confidence that the job has been done right!

Construction requires heavy duty, well tested, drain boards,

and here are some of the qualities that set us apart from the competition:

- We make the heaviest drain boards in the market, which provide high resistance to pull downs.
- Our in-house lab is one of the most comprehensive in the market, we do the following tests on an hourly basis:
  - Notched Izod (ASTM D256-10) which measures impact strength of the drain board
  - Compression Test (ASTM D6364-06) which measures the load bearing capacity of the dimples
  - Thermo-kinetic mixer (ASTM

D1621-00) which helps us with resin formulations to maximize the performance of our drain boards

- Melt Index (ASTM D1238-04) measures the viscosity of our resin formulations
- Density (ASTM D1505-68) measures the effects of recycled resins in our formulations
- 50 ton Injection Molding Machine which allows us to make test samples for quick test results

We use science, not marketing language, to further the quality of our products, and that is what sets DMX products apart from the competition. ■



## RESPECT FOR THE ENVIRONMENT

*DMX uses 100% Virgin Resin in the manufacturing of our drain boards. Our Drainage Boards are 100% recyclable. There are a lot of PCR's available in the market, we choose to work with only the best suppliers.*

*Our on site lab allows us to test the different PCR materials in our resin formulations on an ongoing basis. Due to the inherent variability of PCR, it is important to have the ability to do testing around the clock to maintain resin integrity.*

*Not all PCR's are the same, our drain boards are made from an impact resistant Co-Polymer Polypropylene resin, which provides shatter resistance in cold weather construction work.*

*PCR's can enhance the properties of the drain board as long as the molecular weight of the resin is properly understood and blended to provide superior mechanical qualities.*

*Another important characteristic of PCR is the long-term degradation of the polymer and we overcome these challenges with the addition of highly formulated anti-oxidants and compatibilizers.*

*Just because a drain board claims to use Post Consumer Resin (PCR) does not mean that it will have high quality and long-term stability when used in construction projects.*

*DMX Drain Boards contribute to LEED points on all waterproofing projects.*

*DMX stands out because we use science as our guide for making superior drain boards* ■

**DMX.....Better Science, Better Product**

# DMX DRAIN 5X

## For Horizontal and Vertical Drainage Applications

DMX Drain 5X has a spun bond polypropylene geotextile to create an air gap and drainage channel between the soil and the membrane.

DMX Drain 5X can be used for both residential and light commercial applications. It provides superior ground water control, both in vertical and horizontal applications.

Made from a high strength, virgin HDPE (High Density Polyethylene), DMX Drain 5X is the perfect choice for use in light commercial waterproofing projects. ■

Material	Properties
<p>DMX uses a specially formulated High Density Polyethylene that provides a high environmental stress crack resistance to alkalines and acids found in the soil. Our special extrusion process utilizes low heat and low shear to prevent heat degradation in the final product. The use of antioxidants and lubricants further ensure a smooth, superior quality membrane that outperforms the competition.</p>	<p>The DMX Drain 5X™ drainage board finished product has a 0.031' (8 mm) dimple height, providing a drainage capacity of 12 gal/min/ft of width and a compressive strength of 6,000lbs/sq ft. Polyethylene is highly resistant to chemical interaction and has a life expectancy of up to 50 years when properly installed in accordance with the manufacturer's instruction.</p>

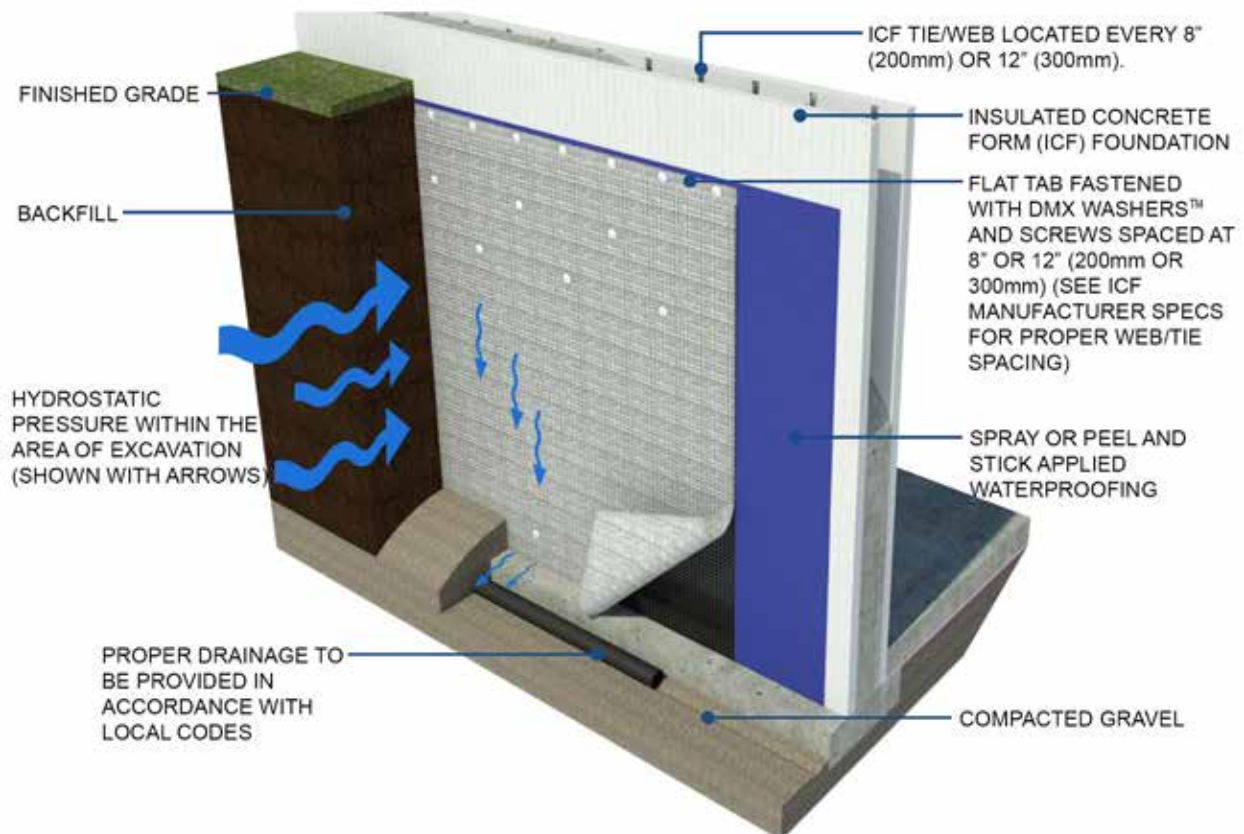

# DMX DRAIN 11X

## For Horizontal and Vertical Drainage Applications

This high quality drain board which has a compressive strength of 11,000 psf, is the contractor's preferred choice for light commercial and shallow foundations.

DMX Drain 11X can be used for both horizontal and vertical drain applications. It provides superior ground water control.

Made from a high strength, shatter resistant Co-polymer PP, DMX Drain 11X is the perfect choice for use in light commercial waterproofing projects. ■

Material	Properties
<p>DMX uses a specially formulated Polypropylene that provides a high environmental stress crack resistance to alkalines and acids found in the soil. In addition, DMX is made from 100% virgin resin. Our special extrusion process utilizes low heat and low shear to prevent heat degradation in the final product. The use of antioxidants and lubricants further ensure a smooth, superior quality membrane that outperforms the competition.</p>	<p>The DMX Drain 11X™ drainage board finished product has a 10mm dimple height, providing a drainage capacity of 18 gal/min/ft of width and a compressive strength of 11,000lbs/sq ft. Polypropylene is highly resistant to chemical interaction and has a life expectancy of up to 50 years when properly installed in accordance with the manufacturer's instructions.</p>

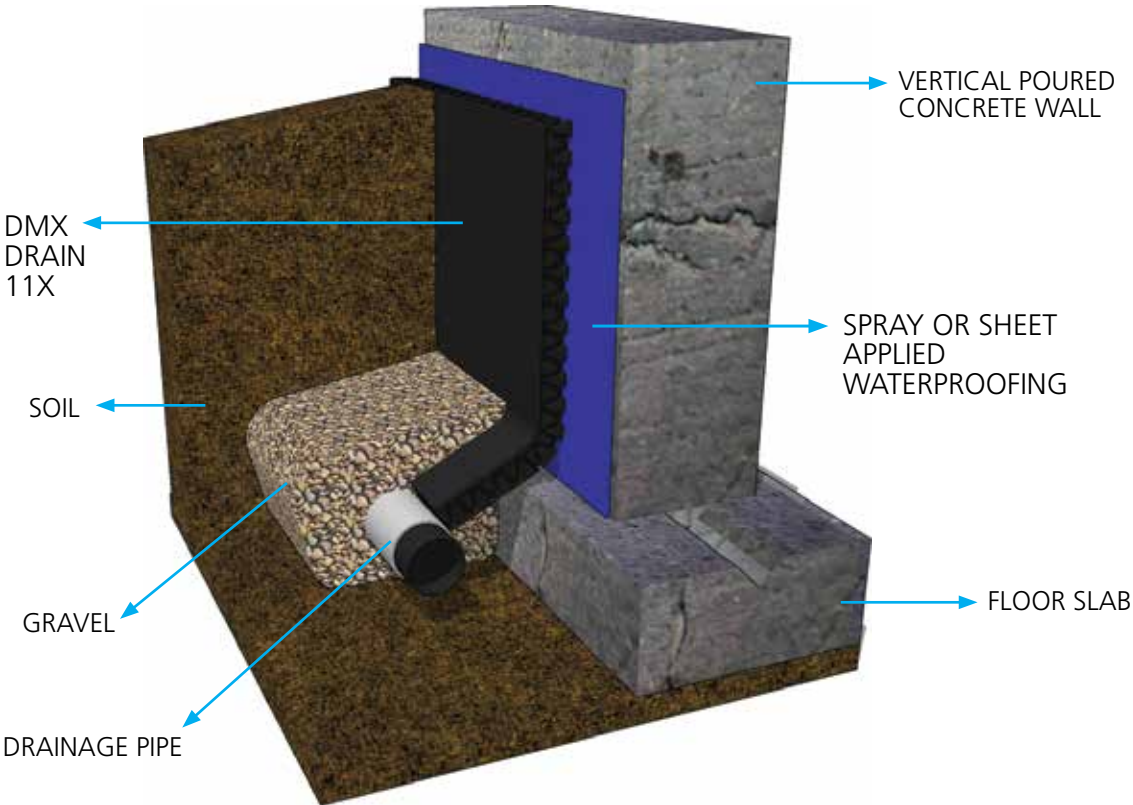

# DMX DRAIN 15X

## For Horizontal and Vertical Drainage Applications

This is the most commonly used drain board (15,000 psf) in waterproofing applications.

DMX Drain 15X is used in applications where high compressive strengths and high water flow rates are required.

Attention to polymer blends and exacting in-house testing ensures that DMX Drain 15X is up to the job on the construction sites.

DMX Drain 15X is the contractor's preferred choice for the following types of applications:

- Deep foundation walls
- Retaining walls

- Caisson walls
- Split slabs
- Structural drainage for tunnels

Made from a high strength, shatter resistant Co-polymer PP resin, and tested for use under high load applications, DMX Drain 15X is the perfect choice for use in applications described above. ■

Material	Properties
DMX uses a specially formulated Polypropylene that provides a high environmental stress crack resistance to alkalines and acids found in the soil. In addition, DMX is made from 100% virgin resin. Our special extrusion process utilizes low heat and low shear to prevent heat degradation in the final product. The use of antioxidants and lubricants further ensure a smooth, superior quality membrane that outperforms the competition.	The DMX Drain 15X™ drainage board finished product has a 10mm dimple height, providing a drainage capacity of 18 gal/min/ft of width and a compressive strength of 15,000lbs/sq ft. Polypropylene is highly resistant to chemical interaction and has a life expectancy of up to 50 years when properly installed in accordance with the manufacturer's instructions.

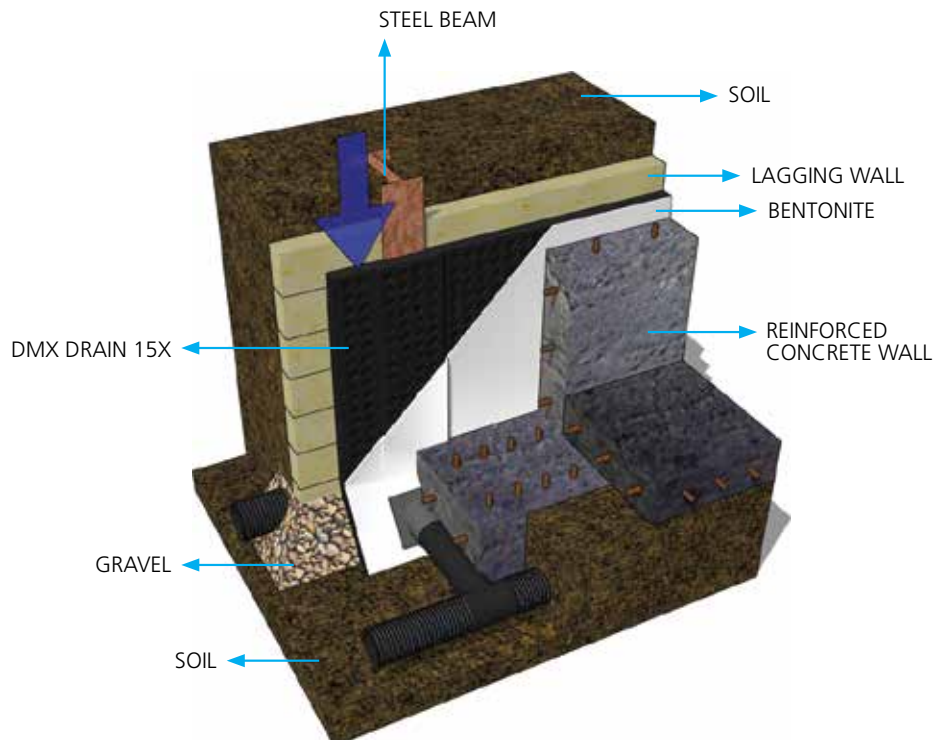



# DMX DRAIN 15XP

## For Horizontal and Vertical Drainage Applications

DMX Drain 15XP comes with a 6 Mil Poly-backing glued to the negative side of the drain board.

This is the most commonly used drain board (15,000 psf) in waterproofing applications.

DMX Drain 15XP is used in applications where high

compressive strengths and high water flow rates are required.

Attention to polymer blends and exacting in-house testing ensures that DMX Drain 15XP is up to the job on the construction sites.

DMX Drain 15XP is the contractor's preferred choice for the following types of applications:

- Deep foundation walls

- Retaining walls
- Caisson walls
- Split slabs
- Structural drainage for tunnels

Made from a high strength, shatter resistance Co-polymer PP resin, and tested for use under high load applications, DMX Drain 15XP is the perfect choice for use in applications described above. ■

Material	Properties
DMX uses a specially formulated Polypropylene that provides a high environmental stress crack resistance to alkalines and acids found in the soil. In addition, DMX is made from 100% virgin resin.. Our special extrusion process utilizes low heat and low shear to prevent heat degradation in the final product. The use of antioxidants and lubricants further ensure a smooth, superior quality membrane that outperforms the competition.	The DMX Drain 15XP™ drainage board finished product has a 10mm dimple height, providing a drainage capacity of 18 gal/min/ft of width and a compressive strength of 15,000lbs/sq ft. Polypropylene is highly resistant to chemical interaction and has a life expectancy of up to 50 years when properly installed in accordance with the manufacturer's instructions.

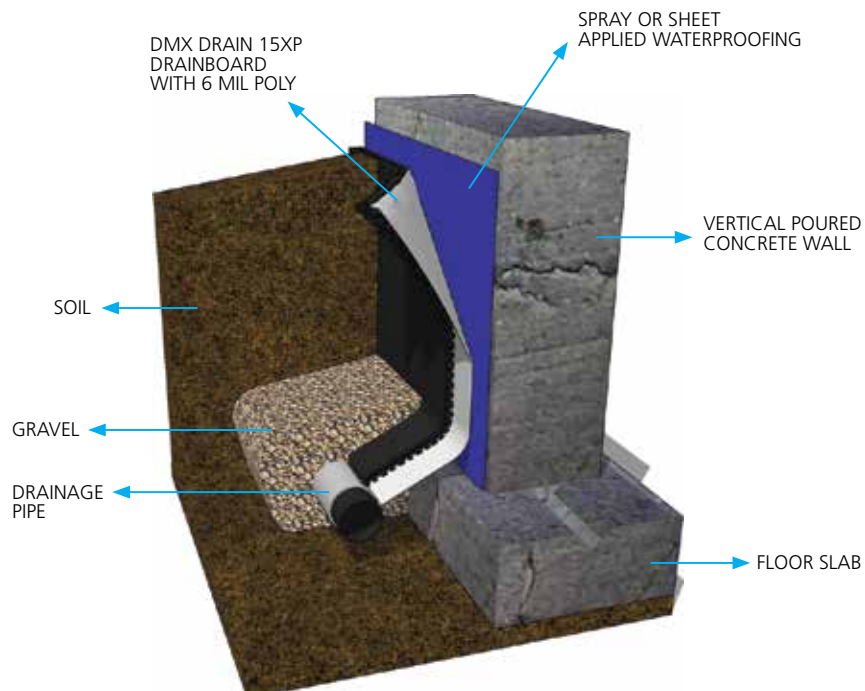

# DMX DRAIN 18X

## For Horizontal Drainage Applications Under Gravel, Pavers, or Concrete

DMX Drain 18X is a high performance drain board that has the ability to withstand loads up to 18,000 psf.

This drain board is preferred choice for plaza decks, planters and pavers.

Made from a high strength, shatter resistance Co-polymer PP resin, and tested for use under high load applications, DMX Drain 18X is the perfect choice for use in green roofs. ■

Material	Properties
DMX uses a specially formulated Polypropylene that provides a high environmental stress crack resistance to alkalines and acids found in the soil. In addition, DMX is made from 100% virgin resin.. Our special extrusion process utilizes low heat and low shear to prevent heat degradation in the final product. The use of antioxidants and lubricants further ensure a smooth, superior quality membrane that outperforms the competition.	The DMX Drain 18X™ drainage board finished product has a 10mm dimple height, providing a drainage capacity of 18 gal/min/ft of width and a compressive strength of 18,000lbs/sq ft. Polypropylene is highly resistant to chemical interaction and has a life expectancy of up to 50 years when properly installed in accordance with the manufacturer's instructions.

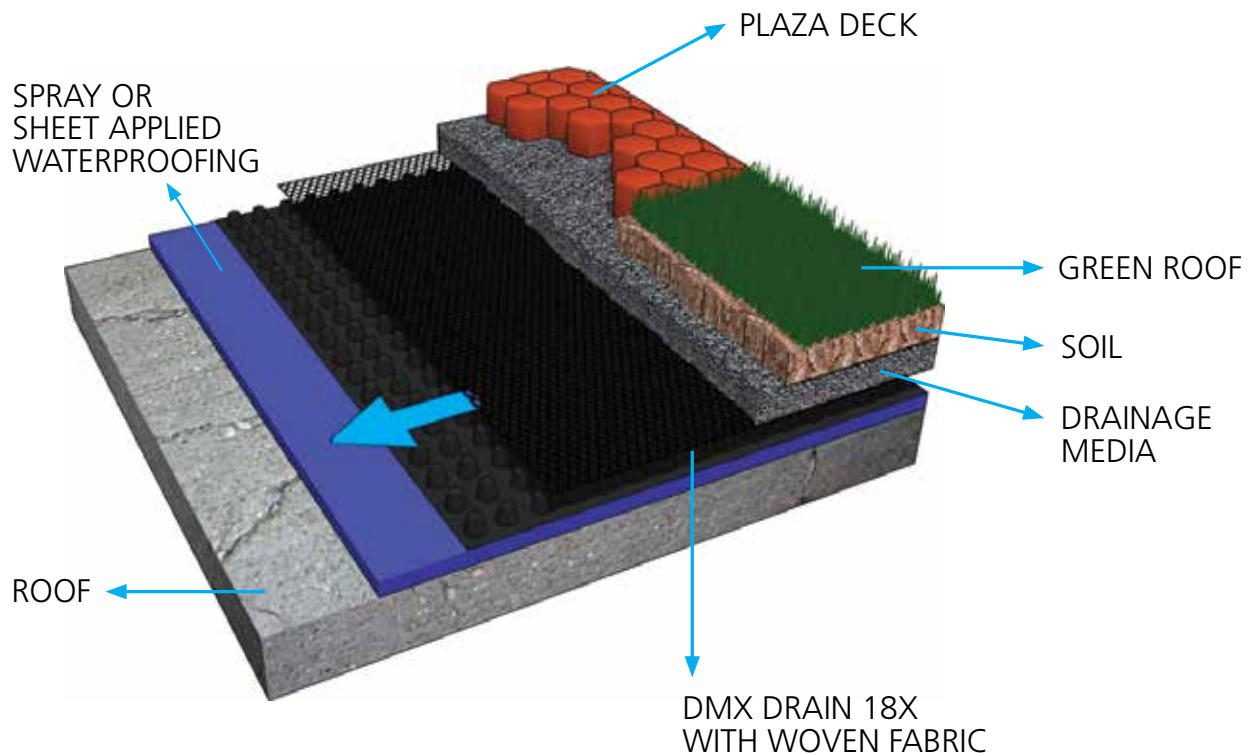

# TECHNICAL DATA

	DMX DRAIN 5X	DMX DRAIN 11X	DMX DRAIN 15X	DMX DRAIN 15XP	DMX DRAIN 18X
<b>Drainage Core</b>					
Colour	Black	Black	Black	Black	Black
Dimension (W x L)	5 x 50ft, 6.6 x 50ft, 8 x 50ft 1.53, 1.98, 2.44 x 15.25m	4 x 50ft, 6 x 50ft 1.22, 1.83 x 15.25m	4 x 50ft, 6 x 50ft 1.22, 1.83 x 15.25m	4 x 50ft, 6 x 50ft 1.22, 1.83 x 15.25m	4 x 50ft, 6 x 50ft 1.22, 1.83 x 15.25m
Compressive Strength	6,700 psf 320 kNm <sup>2</sup>	11,000 psf 527 kNm <sup>2</sup>	15,000 psf 718 kNm <sup>2</sup>	15,000 psf 718 kNm <sup>2</sup>	18,000 psf
Thickness	5/16 inch 8 mm	7/16 inch 10 mm	7/16 inch 10 mm	7/16 inch 10 mm	7/16 inch 10 mm
Material	Polyethylene	Polypropylene	Polypropylene	Polypropylene	Polypropylene
<b>Filter Fabric</b>					
Grab Tensile Strength	110 lbs 0.49 kN	90 lbs 0.401 kN	90 lbs 0.401 kN	90 lbs 0.401 kN	365 x 200 lbs 1.62 x 0.89 kN
Grab Elongation	50.00%	50.00%	50.00%	50.00%	15.00%
Trapezoid Tear Strength	40 lbs 0.178 kN	40 lbs 0.178 kN	40 lbs 0.178 kN	40 lbs 0.178 kN	115 x 75 lbs 0.51 x 0.33 kN
CBR Puncture Resistance	30 lbs 0.134 kN	265 lbs 1.178 kN	265 lbs 1.178 kN	265 lbs 1.178 kN	675 lbs 3.0 kN
Permittivity	1.3 sec <sup>-1</sup>	2.0 sec <sup>-1</sup>	2.0 sec <sup>-1</sup>	2.0 sec <sup>-1</sup>	2.1 sec <sup>-1</sup>
Water Flow	95 gpm/ft <sup>2</sup> 3871 l/min/m <sup>2</sup>	150 gpm/ft <sup>2</sup> 6095 l/min/m <sup>2</sup>	150 gpm/ft <sup>2</sup> 6095 l/min/m <sup>2</sup>	150 gpm/ft <sup>2</sup> 6095 l/min/m <sup>2</sup>	145 gpm/sf 5907 l/min/sm
Apparent Opening Size (AOS)	50 Std. U.S. Sieve 0.300 mm	50 Std. U.S. Sieve 0.300 mm	50 Std. U.S. Sieve 0.300 mm	50 Std. U.S. Sieve 0.300 mm	40 Std. U.S. Sieve 0.425 mm
UV Resistance	70%/500 hrs	70%/500 hrs	70%/500 hrs	70%/500 hrs	90%/500 hrs
<b>Composite System</b>					
Water Flow Rate (V)	10 Gal/min/ft 124 L/min/m	18 Gal/min/ft 223 L/min/m	18 Gal/min/ft 223 L/min/m	18 Gal/min/ft 223 L/min/m	18 Gal/min/ft 223 L/min/m
Roll Size	5 x 50ft, 6.6 x 50ft, 8 x 50ft 1.53, 1.98, 2.44 x 15.25m	4 x 50ft, 6 x 50ft 1.22, 1.83 x 15.25m	4 x 50ft, 6 x 50ft 1.22, 1.83 x 15.25m	4 x 50ft, 6 x 50ft 1.22, 1.83 x 15.25m	4 x 50ft, 6 x 50ft 1.22, 1.83 x 15.25m
Roll Weight	39 lbs, 53 lbs, 64 lbs 18 kg, 24 kg, 29 kg	30 lbs, 45 lbs 15 kg, 20 kg	40 lbs, 55 lbs 18 kg, 25 kg	41 lbs, 62 lbs 19 kg, 28 kg	46 lbs, 70 lbs 21 kg, 32 kg

# PHOTO GALLERY





**Toll Free** 1-855-501-7837

**Email** [customerservice@dmxmembranes.com](mailto:customerservice@dmxmembranes.com)

**Address** 165 Orenda Road,  
Brampton, Ontario, L6W 1W3

**Website** [www.dmxmembranes.com](http://www.dmxmembranes.com)



**DMX**